

| ITEM NO. | PART NO. | DESCRIPTION | QTY |
|----------|-----------------|-----------------------------|-----|
| 1 | CTSP60-D00 | DRIVER SIDE VISOR | 1 |
| 2 | CTSP60-G00 | PASSENGER SIDE VISOR | 1 |
| 3 | KTSP60-C00 | UNIVERSAL BRACKET | 1 |
| 4 | B-TP14X1S | TRUSS PHILLIPS 1/4"20CX1"SS | 6 |
| 5 | B-W14SS | 1/4" FLAT WASHER SS | 12 |
| 6 | B-AVDDLS-420165 | INSERT 1/4-20 | 6 |
| 7 | B-HB14X34SS | HEXBOLT 1/4" 20NC 3/4" SS | 6 |
| 8 | B-LW14SS | LOCK WASHER 1/4" SS | 6 |
| 9 | B-NL14-20SS | NYLON LOCK NUTS 1/4"-20 | 6 |
| 10 | B-TP10X1SS | TRUSS PHILLIPS 10-32 X 1" | 2 |
| 11 | B-W10OD12SS | FLAT WASHER 10 OD 1/2" SS | 2 |
| 12 | B-NL10X32SS | NYLON LOCK NUT #10-32NF | 2 |

| TRUX ACCESSORIES | | | |
|--|------------------|-----------------------------|------------|
| TITLE: SUNVISOR BOW TIE PETERBILT SERIE 300 | | | |
| Designed: SM | Date: 2024-01-17 | DWG. NO. TSUN-P60 | |
| Drawn: SM | Date: 2024-01-17 | Rev.: A | Weight: |
| Approved: RV | Date: 2024-01-17 | Size: A | Scale: 1:6 |
| | | Sheet: 3 OF 4 | |

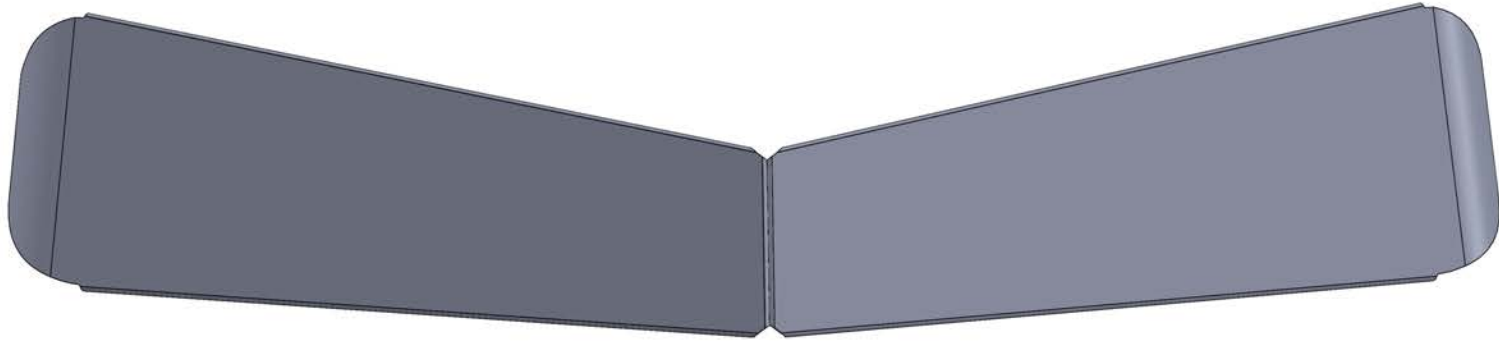

INSTALLATION INSTRUCTIONS

- 1- REMOVE THE EXISTING SUN VISOR.
- 2- DRILL HOLES AND INSERT WELLNUTS.
- 3- INSTALL THE BRACKETS ONTO THE CAB.
- 4- TEMPORARILY INSTALL THE SUN VISOR AS ILLUSTRATED.
- 5- USING THE SUN VISOR, MARK OUT HOLES ON BOTH ENDS OF SUN VISOR.

ATTENTION

REMOVE SUN VISOR TO PREVENT DAMAGE

- 6- DRILL THE PREVIOUSLY MARKED OUT HOLES.
- 7- INSERT THE WELLNUTS.
- 8- REINSTALL THE SUN VISOR ON THE CAB.
- 9- TIGHTEN ALL BOLTS AND SCREWS FIRMLY.

| TRUX ACCESSORIES | | | | |
|--|------------------|-----------------------------|------------|---------------|
| TITLE: SUNVISOR BOW TIE PETERBILT SERIE 300 | | | | |
| Designed: SM | Date: 2024-01-17 | DWG. NO. TSUN-P60 | | |
| Drawn: SM | Date: 2024-01-17 | Rev.: A | Weight: | |
| Approved: RV | Date: 2024-01-17 | Size: A | Scale: 1:8 | Sheet: 4 OF 4 |